



## For Lease

Almost **5800 s.f.**

**1110 Airport Street**

**(200 yards from Queen City Parkway)**

**Gainesville, GA**

**REDUCED TO \$1,900/month!**

**On lockbox for easy showing**

[Quick Link for more info](#)

- ◆ Two computer-wired offices
- ◆ Full cement, fenced mezzanine
- ◆ Two enclosed loading docks w/levelers
- ◆ 12' x 16' drive-in door
- ◆ Cement outdoor storage
- ◆ 3-phase power/210 jacks
- ◆ Two ventilation fans
- ◆ Glass front
- ◆ Gas heat/Georgia Power
- ◆ 18' ceilings





# Prudential Georgia Realty **BrentHoffman.com**

*“When You Want It Sold”*



One of two offices, each with its own closet and windows.



Personnel door next to 12x16 drive-in door. Mezzanine is on the left.



Ceilings are between 17 and 20 ft., with brand-new, high-efficiency lighting.



View from 562 s.f. cement, fenced mezzanine.



Two covered loading docks w/levelers.



Huge parking lot with LOTS of spaces and fenced area for trucks.

**All this, plus a meticulous Landlord to make your business look good!**  
**DIRECTIONS: I-985 to exit 22, west 1/2 mile to Airport Rd., right to HFC, left to get to the front entrance.**



For more information call Brent at 770.533.6721,  
or e-mail [Brent@BrentHoffman.com](mailto:Brent@BrentHoffman.com).  
More property information at [www.BrentHoffman.com](http://www.BrentHoffman.com)  
Prudential Georgia Realty—770.536.3007



FLOOR PLAN  
1110 AIRPORT ROAD

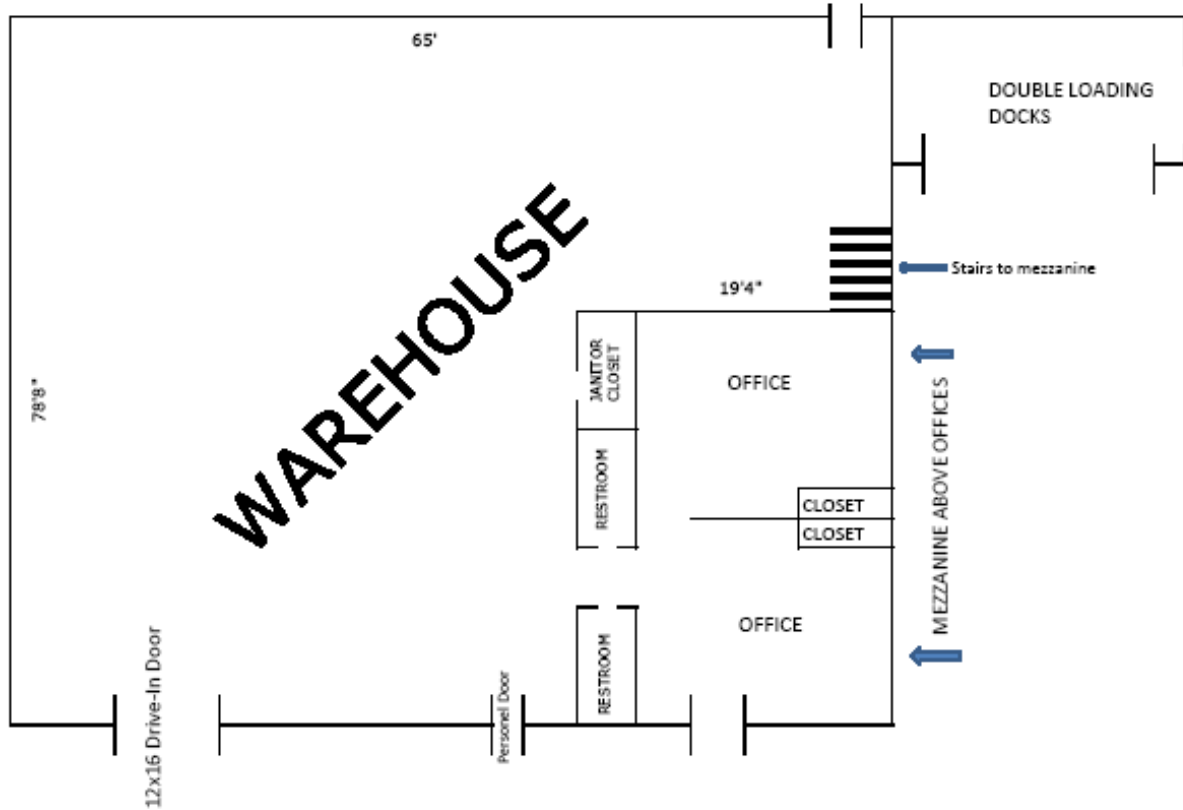

For more information call Brent at 770.533.6721,  
or e-mail [Brent@BrentHoffman.com](mailto:Brent@BrentHoffman.com).  
More property information at [www.BrentHoffman.com](http://www.BrentHoffman.com)  
Prudential Georgia Realty—770.536.3007