

FOR LEASE—CLASS A OFFICE SUITES ON 3RD FLOOR
Recently Renovated and Re-divided
\$15.00 p.s.f + \$6.80 CAM

Suite 2 – 1,730 s.f. w/ lg reception and 3 offices -
1 large enough for several desk/bullpen

Suite 3 – 1,750 s.f. w/ reception 4 offices & break room



Above United Community Bank

351 Jesse Jewell Parkway, Gainesville

- ◆ Located in Mid-town Opportunity zone with tax incentives
- ◆ Located on Highland to Islands trail
- ◆ Centrally located
- ◆ Lighted access off Jesse Jewell
- ◆ High Visibility
- ◆ Extensive Parking
- ◆ **SEE NEW VIDEOS ON WEBPAGE**



SEE NEW FLOOR PLAN ON PAGE 5



500 Jesse Jewell Pkwy., SE Suite 300
Gainesville, GA 30501
770-533-6721 (Direct) 770-536-3007 (Office)
Brent@BrentHoffman.com www.BrentHoffman.com

Suite 2- 1,730 s.f. with reception and 3 offices + large reception - one could be XTRA-LARGE training room or bull pen area



Reception / Entry Hallway



Hallway to 3 offices



"Training or Bull Pen" area



Large corner office



Direct elevator access



3rd floor view

Suite 3—1,750 s.f. with 4+ offices - break room - reception area



Receptionist area- plenty of window light!



Lg corner office or conference



Additional Office



Break Room



Extensive parking in a park like setting



Traffic light access

Extensive parking

Easy multiple access



Convenient to downtown and I-985

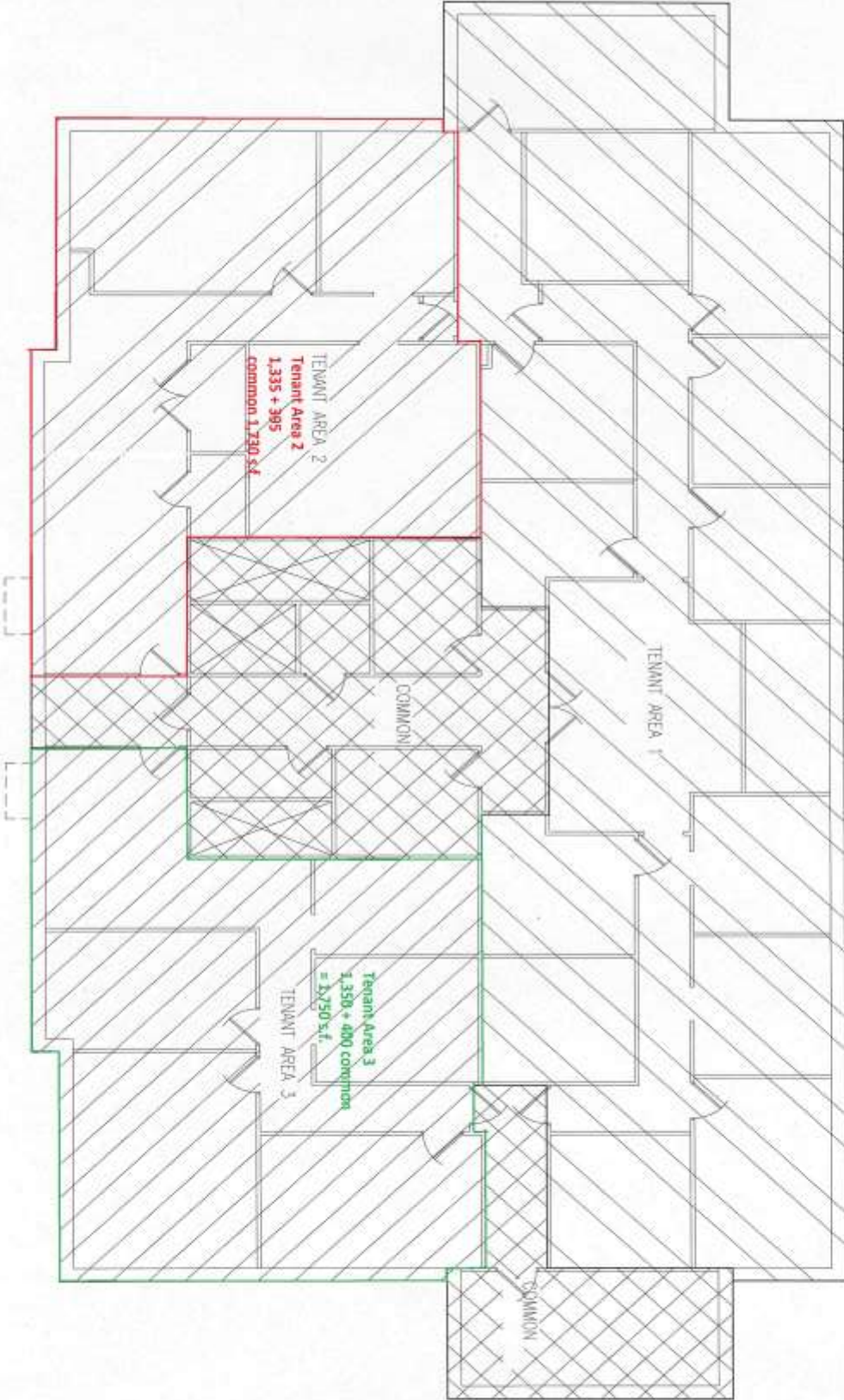

SUMMARY OF AREAS

TENANT	COMMON	TOTAL
TENANT 1: 2552	683 =	3235 SQ. FT.
TENANT 2: 1335	395 =	1730 SQ. FT.
TENANT 3: 1350	400 =	1750 SQ. FT.
TOTAL:		6715 SQ. FT.

DATE: 03.08.2019	TRINITY ENGINEERING GROUP P.C. 100 TOWN CENTER BUILDING SUITE 1000, GAINESVILLE, FL 32609 TEL: 352.335.1100 FAX: 352.335.1101
UNITED COMMUNITY BANK BUILDING 3RD FLOOR GAINESVILLE, GA 32609	
PROJECT NO: 2017-100 CLIENT: K&H TITLE: 125617	REVISIONS: NO. DESCRIPTION 1 2 3 4 5 6 7 8 9 10